



THE WOLVERINE UPDATE

www.wolvgroup.com

Problem Solver. Innovator. Since 1939.

Winter/Spring 2011



MIDWEST CITY, WORLD CLASS CARE

WOLVERINE BUILDING GROUP COMPLETES HELEN DEVOS CHILDREN'S HOSPITAL

With immense pride, Wolverine Building Group celebrates the completion of the new Helen DeVos Children's Hospital, a 14 floor state-of-the-art children's hospital in downtown Grand Rapids, MI. Bringing world-class pediatric care to West Michigan, the highly anticipated project offers an abundance of exceptional medical services in magical surroundings. The 464,000 square foot hospital contains a stand alone emergency department, radiology department, inpatient and outpatient surgery, neonatal intensive care unit, pediatric critical care unit, medical/surgical patient rooms, classrooms, media center, chapel, and public gathering spaces.

CONTINUED ON PAGE 3



OUTLOOK FOR 2011

The spring construction season is here, and we are feeling optimistic about West Michigan and its strong business leaders. It is not an easy environment for Michigan business right now, and many companies are struggling, however, the strong survivors in our region are actually doing quite well. We are still finding new customers for Wolverine Building Group, and we are fortunate to continue working with our great repeat customers.

We are very proud to announce that we just completed one of the world's best children's hospitals for Spectrum Health, the Helen DeVos Children's Hospital. We are currently busy on several major projects, including new construction of Farmers Insurance Call Center and Print Distribution Center in Caledonia, as well as the historic renovations of Division Park Avenue and Serrano Lofts in downtown Grand Rapids. Our North America team is working on projects around the nation for Red Robin, McDonalds, Taco Bell, and Best Buy. We are also working on the largest new apartment projects in the state, including the 300,000 square foot student housing development, The Lodges of East Lansing.

We remain focused on the basics of our operations, and our core values of Integrity, Enjoyment, Quality, and Improvement to help guide all of our decisions. We emphasize planning, speed, quality, safety, and cleanliness for all of our projects. **Quality customer service and satisfied clients** is the key to our success and earns us repeat work. We continuously expand our knowledge and expertise in our clients' industries so we can serve them better.

We are proud to report that we have a very strong balance sheet, and we are poised to take advantage of opportunities that may come our way as the economy recovers. We have streamlined our operations and united behind one name, Wolverine Building Group, with the vision to build the best industrial, commercial, medical, and multi-family buildings in Michigan and beyond.

We are still investing in technology and in training for our professionals. All of our superintendents and project managers are equipped with smart phones in order to communicate quickly and accurately, with each other and with our customers. We are dedicated to developing and retaining the best and brightest construction talent in Michigan.

Our future is bright because we have such a valuable team at Wolverine Building Group. We treat our customers fairly, and with excellent service, making them want to hire us again and again. We want to be known as **capable, professional, and easy to work with**. **Repeat clients** are our goal, and we appreciate your business.



Richard VanderZyden, *President*
Michael Kelly, *President*

TODD WENZEL AUTOMOTIVE

PARADE OF UPGRADES



Wolverine completed remodels of the two Todd Wenzel Automotive locations, Todd Wenzel Buick GMC in Grand Rapids and Todd Wenzel Chevrolet in Hudsonville. The renovations were part of a nation wide push by General Motors to create brand identity and attract more customers to dealership show rooms.

Project Manager Jim Ziegler and Superintendents Fred Gilbert and Dave DeWaard headed the projects' upgrades to the show rooms, offices, and service centers.

Wolverine teamed up with architect Design Plus on both projects. The 11,000 square foot Grand Rapids location was completely stripped out and the interior was completely rebuilt. The 6,500 square foot Hudsonville location also

received an extensive interior remodel along with a 2,500 square foot service department addition. Wolverine also constructed a new eye-catching exterior canopy at each dealership to create an inviting entrance into the showrooms.



"Bringing the facilities in line with current GM standards provides a fresh look that will encourage car shoppers to feel more confident about their next purchase."

**-Project Manager
Jim Ziegler**

A STRONG TEAM

Vastly different than anything else in the Grand Rapids skyline, the Helen DeVos Children's Hospital curved glass tower design is as unique outside as it is inside. The goal was to design a children's hospital that would captivate children, without being childish, to house the latest technology demanding the most talented doctors and specialists, and to create a warm, healing environment for the thousands of families it will help each year.

Wolverine Building Group worked with Helen DeVos Children's Hospital staff and URS Health to create an unparalleled LEED certified design. Built into the Michigan Street Hill to maximize the space of each floor, the first three floors contain many of the procedural spaces, from there the hospital expands into an 11-floor tower with circular floor plans, giving unique curvature to almost every room and hallway within.

Since many concepts were original and never created before, much team collaboration was necessary between Wolverine, designers, engineers, and specialty contractors. Many of the challenges involved orchestrating the technical requirements of a hospital with the sophisticated design of the building. Wolverine's team was able to successfully interpret the designers' vision into a constructible, affordable and maintainable project. Value Engineering ideas offered comparable quality at more affordable prices and saved an additional \$10 million from the overall project budget.

Devoted to the project for the past four years, Wolverine's healthcare team turned over the building with both excitement and sentiment. Wolverine's team managed more than 2,400 workers on site totalling over 1.2 million man hours, and completed the project with a strong safety record. The team included Project Managers Aaron Davis and Matt Zimmerman, and Superintendents Tim Gray, John DenOuden, Ralph Faulkner, John Booms, Tim Broilo, Dave Gray, and Brian Hanson.

CONTINUED ON PAGES 3 & 4

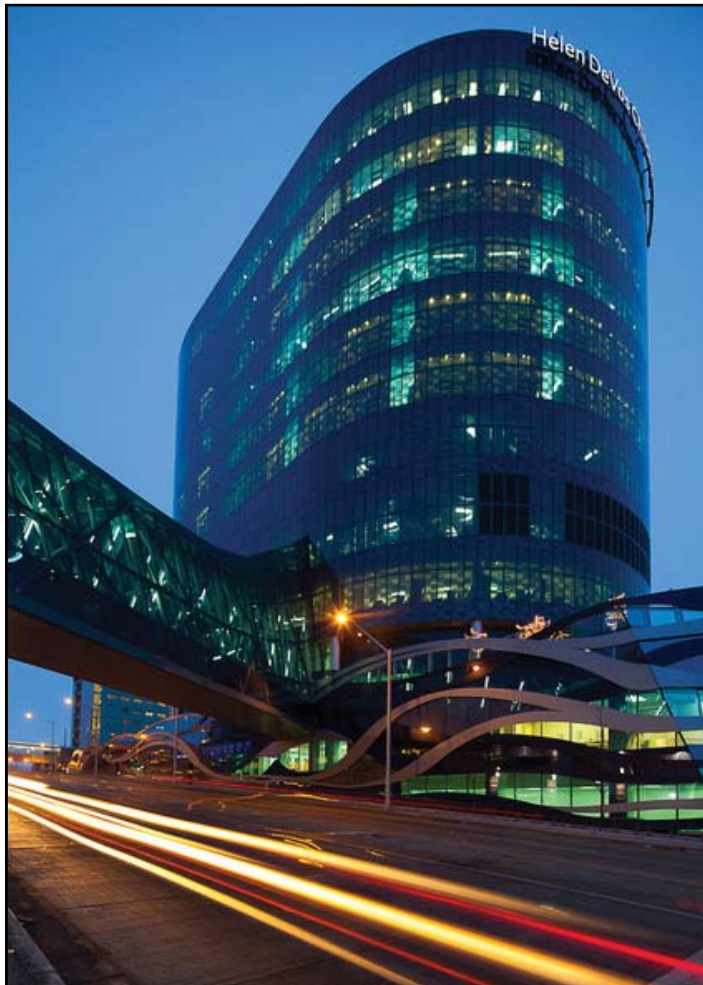

"Of all the projects I have worked on in the past 20 years at the hospital, the children's hospital was the most challenging, and the most rewarding!

It was especially moving to see the children at the open houses. They were wide-eyed and excited and did not associate this building with the fear a child will have going to the doctor.

The entire team did a terrific job, and after four years it was a sad feeling to have to hand the building over."

-Head Superintendent, Tim Gray

UNIQUE FEATURES OF HELEN DEVOS CHILDREN'S HOSPITAL

Full Vision Glass Exterior: Engaging from Inside and Out

With its whimsical “wave” glass curtainwall base and deep blue circular glass tower, this building is eye-catching from every direction.

The podium base of the building plays off the motion, colors, and feel of a day at a Lake Michigan beach. The arched waves were strategically placed to hide the glass color transition points and to give the base more curvature. The lower façade has depth and interest and appears as if it is made of random blue and silver waves filled in with blue, green and clear glass.

The patient tower is a sleek, four sided glazed curtainwall system with fritted arctic blue glass. It is the first hospital tower in the world skinned with 100 percent vision glass. Nowhere else has a structure like this utilized such an innovative system. The

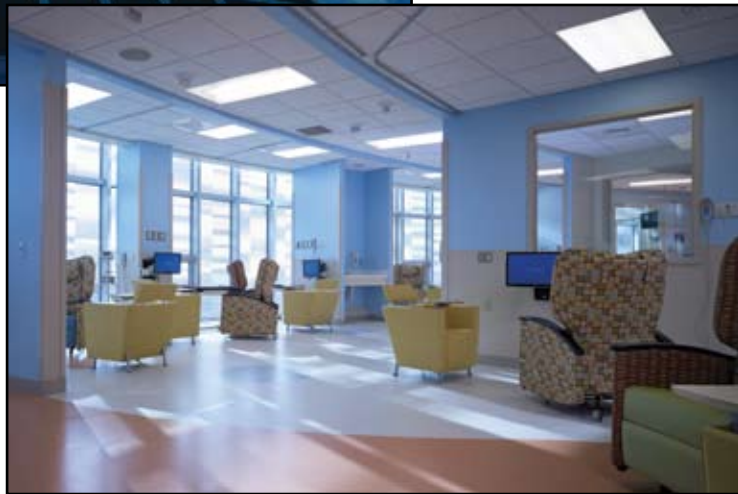

“It has been incredible to be a part of a project that has brought the best possible pediatric care to West Michigan. This experience will be one I will look back on with fond memories for the rest of my career.”

-Project Manager
Matt Zimmerman

curtainwall system allows the the exterior of the building to be bright and uniform, while allowing an abundance of natural light inside. The custom frit pattern was carefully designed to allow for unobstructed views at varying heights from the interior, but also to provide shade for the interior minimizing the required energy to cool the building.

Pedestrian Bridge Entrance: A Spectacular Front Door

The pedestrian bridge connects the hospital parking ramp to the children’s hospital, serving as the main entrance and first impression of the building for a majority of the visitors. As the “front door” of a world class hospital, the bridge is an inviting introduction to the building. The 194’ long bridge is comprised of a rotating structural pipe frame bridge that begins at 14’ high at the parking ramp and sweeps up to 44’ high peak at the hospital entrance. The steel frame is clad with an arctic blue glass skylight system.

Due to the size of the structural frame, a majority of the bridge was fabricated in the street adjacent to the hospital and then set in place by crane. Building Information Modeling (BIM) and 3-D laser scanning were used extensively to maintain construction tolerances. The glass cladding has 628 unique glass sizes and shapes custom fitted to the steel frame. No two pieces are alike. Excellent communication and coordination between trades was critical to the successful completion of this piece of the project.

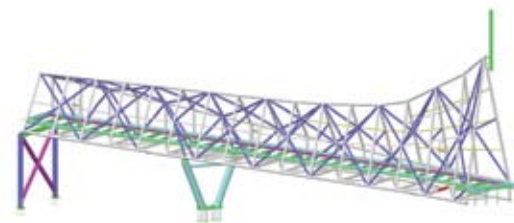

Patient Rooms: Designed for Patient, Family and Care Giver

Floor to ceiling window-walls are a main design feature of the patient rooms. Motorized shades allow for easy control of the view, and the glass allows for the room to be full of natural light and a magnificent view overlooking Grand Rapids.

Colorful private patient rooms are designed to provide efficient space for the patient, the patient’s family, and the care givers. The family space in a typical patient room includes a wardrobe, a refrigerator, television, and an extendable couch for overnight stays. Work stations are located right outside of the patient rooms and are laid out to be minimally obtrusive to the patients and their families.

Lobby/Urban Park/Ice Cream and More

The main lobby for the children’s hospital is an entrance equal to the pedestrian bridge. Every direction a child looks, there is an interesting detail to allow their imagination to run free.



Behind the welcome desk is a 42’ long curved bubble wall that extends 19’ up to the translucent lighted ceiling above. Nearby, an interactive play wall runs with infrared sensors that allows for multiple participants to play simultaneously in games where their body is the game controller.

There is a large gift shop designed specifically for children’s gifts, toys, games, and activities. Children will also enjoy the restaurant options including wood fired pizza, an ice cream parlor, and a coffee kiosk.

Child-engaging art work is an important part of the lobby, including a large ceramic tile mural that incorporates art work created by local children and interactive water sculpture. There is a stage for performances and classrooms and media areas for education.

An exterior plaza houses an urban park playground with interactive play pieces, trees and landscaping making the entire lobby level a fun distraction for children and their families.

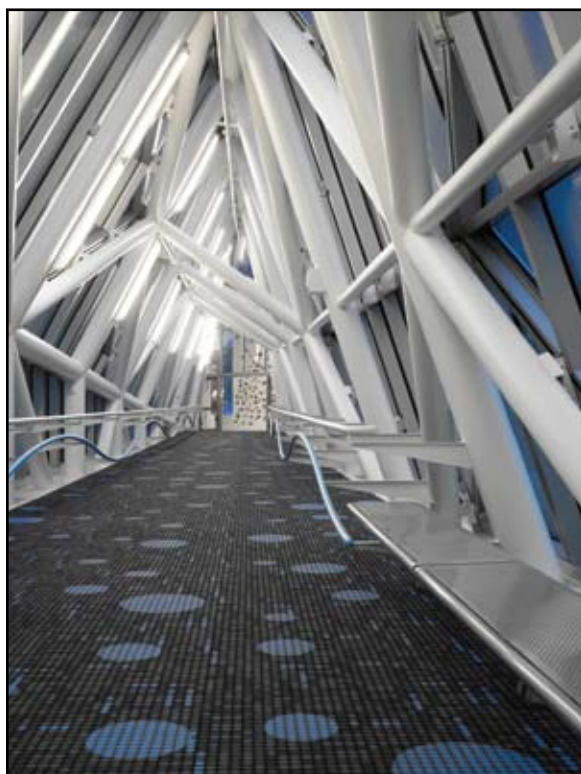
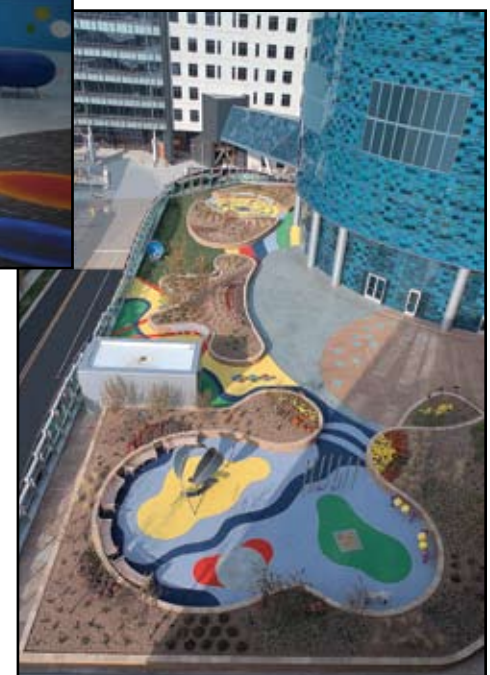

CUTTING TIME AND BUDGET

Wolverine Building Group is proud to announce the completion of the new East Grand Rapids Public Works Complex located off Reeds Lake Blvd. The \$1.2 million project included an extensive renovation to the existing 17,200 building along with a 6,000 square foot addition.

Wolverine's Project Manager Brandon Hartel and Superintendent Howard Gilbert, were able to cut the project schedule in half by coordinating with city workers, and relocating them into temporary office space on site during construction. Working on the unoccupied building allowed Wolverine to expedite construction and finish the project months ahead of the original completion date set for June of 2011. This early completion date also helped the city spend less of their allocated budget for the project.

The renovated portion of the building houses a wood shop, a parts storage area, and a garage in which to store the city's maintenance vehicles such as snowplows, sweepers, and dump trucks. The addition includes the city's new vehicle service center, a mezzanine for storage, office area, sleeping accommodations for third shift employees, showering facilities, and a full kitchen.



SLEEPING BEAR DUNES

PRESERVING HISTORY

The Sleeping Bear Dunes National Lakeshore has a rich history of shipping, logging, and agriculture. Glen Haven was developed as a little historic logging village located on the shore of Lake Michigan. To help preserve the historic town and the natural lands surrounding the lakeshore, Wolverine was hired to construct designated pedestrian trails and parking to help accommodate tourist traffic during summer months. The \$850,000 project, led by Project Manager Bill Pursifull and Superintendent Kelly Donat, included the construction of wooden boardwalks and concrete walkways, three beach access trails, and six areas of parking. An elevated boardwalk path to view a historic fishing tug, a commemoration of the area's heritage as a shipping port, was also constructed.



TOM'S QUICKSTOP



FUN AND EFFICIENT

It's hard to miss Tom's Fuel Center off of Interstate 96 in Portland, MI. The fuel center and convenience store are accompanied by a striking 8,000 square foot car wash, different from any other around. The new sky-lite tunnel contains the latest technology in car wash systems and provides the most efficient cleaning for any sized vehicle. The colorful soaps and the unique cylindrical structure make the car wash experience interesting and fun. Wolverine's team, Project Manager Jim Reyers and Superintendent Dave Novak, completed the \$2.5 Million project in just three months.

CURRENT PROJECTS

- 5/3 Ballpark Suite Upgrades: Comstock Park, MI
- Arby's: Parma, OH
- Barnett Station: Shelby, MI
- Beene Garter: Grand Rapids, MI
- The Lodges of East Lansing: East Lansing, MI
- Division Park Avenue: Grand Rapids, MI
- **Dutton Fire Station:** Gaines Township, MI (1)
- Farmers Insurance Call Center and Print Distribution Center: Caledonia, MI
- Flagstar Bank: Cascade Township, MI
- KPM USA, Kawasaki: Grand Rapids, MI
- **Oak Meadows:** Albion, MI (2)
- Precision Date Products: Grand Rapids, MI
- Red Robin: Frederick, MD
- Red Robin: Gurnee, IL
- Serrano Lofts: Grand Rapids, MI
- Spectrum Health Butterworth Campus Miscellaneous Projects: Grand Rapids, MI
- Standart Lofts: Toledo, OH
- Taco Bell Upgrades: 42 Locations
- VW Ventures: Kentwood, MI
- Windsong Apartments: Ann Arbor, MI



1



2



3



4



5



6

RECENTLY COMPLETED

- **ALDI:** Cascade Twp, MI (3)
- Arby's: Seven Locations, OH
- **Douglas Apartments:** Kalamazoo, MI (5)
- Durant Hotel: Flint, MI
- East Grand Rapids Municipal Garage: East Grand Rapids, MI
- Grand Rapids First: Wyoming, MI
- Greenville Wellfield: Greenville, MI
- Helen DeVos Children's Hospital: Grand Rapids, MI
- Goodrich Building Remodel: Grand Rapids, MI
- Kentwood District Library: Kentwood, MI
- Oxford Street Trail: Grand Rapids, MI
- Private Hangar, GFIA: Grand Rapids, MI
- **Peppinos Ristorante:** Gaines Twp, MI (4)
- **Red Robin:** Falls Church, VA (6)
- Reeds Lake Trails: East Grand Rapids, MI
- Sleeping Bear Dunes Site Work: Glen Haven, MI
- Spectrum Butterworth Burn Unit: Grand Rapids, MI
- Todd Wenzel Automotive: G.R., MI & Hudsonville, MI
- Tom's QuickStop: Portland, MI
- Walker Standale Trail: Walker, MI
- W. MI Shared Hospital Laundry: Grand Rapids, MI

ANNIVERSARIES

RICK SMITH	27
JACK EYER	24
LARRY WOLTERS	23
RICHARD VANDERZYPEN	22
TIM GABRIELSE	20
KELLY DONAT	17
DAVE BRUMMEL	16
PAT LIVINGSTON	15
ADAM TUFFS	15
AMY HOPPE	11
ROG SCHUTTER	11
MARK BRADBURN	10
DAVE GRAY	8
JUSTIN WIERENGA	7
MIKE STEIN	5
AARON DAVIS	4
JEFF KOSTER	3
TIM LENTERS	3
KURT ADAMS	2

CONGRATULATIONS!



Congratulations to Tim and Gayle Lenters on their third child, Matthew Ryan, born January 13th, 2011, at 6lbs. 9oz



Congratulations to Marcus and Emily Ringnalda bringing their first child into the world January 4th, 2011. Charlotte Jane was born 8lbs 30z.



Proud parents Murph and Lisa Penninga welcomed their second child, Jackson Scott, on September 23, 2010, at 7lbs 9oz. Congratulations!

HAIL THE MIGHTY TRAILS

The interest in public trail systems has become increasingly popular and Wolverine is helping pave the way. Project Manager Brandon Hartel and Superintendents Mike Bilski and Rick Smith recently completed two trail projects, the Reeds Lake Trail in East Grand Rapids (shown left), and the Walker

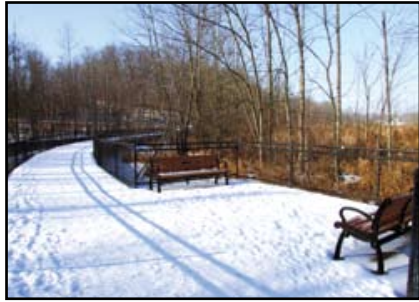

Standale Trail in Walker (shown below).

The Reeds Lake Trail encircles Reeds Lake, giving locals safe recreational pathways that are highly trafficked all year round. The project was completed in two phases. The first was the replacement of a 1,200 foot long elevated boardwalk over wet grassland, and the second included the construction of a mile long trail along the east side of the Lake's community.

The Walker Standale Trail is an extension of the Kent Trails System that travels north from Butterworth Street to Remembrance Road. The project includes four miles of paved pedestrian pathway with five elevated wooden boardwalks over wetland areas. There are future plans to continue the trail further north.



FAITH HOUSE OPENS

Wolverine is proud to announce the opening of Faith House in Grand Rapids, MI, an assisted living facility for developmentally disabled adults. Wolverine, along with several subcontractors at the Helen DeVos Children's Hospital, volunteered on the construction of the house. The team wanted to work together as skilled construction contractors to give something meaningful back to the community and be a part of what makes West Michigan a great place to live.

Check us out at: www.wolvgroup.com

4045 Barden SE, Grand Rapids, MI 49512
Ph: 616-949-3360 Fax: 616-949-6211